



Strut Elements

PG30 machine guard unit: H=1400mm, PG40 40x40 light strut profile recommended;
 H=1800mm, special PG40 40x80 profile for strut elements recommended
 PG40 machine guard unit: H=1400mm, PG45 45x45 light strut profile recommended;
 H=1800mm, special PG45 45x90 profile for strut elements recommended



+

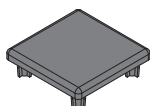

+

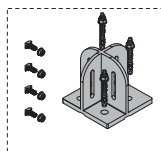

=

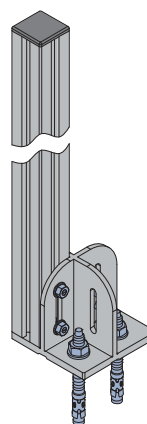

Page 20

Page 21

Page 22-24

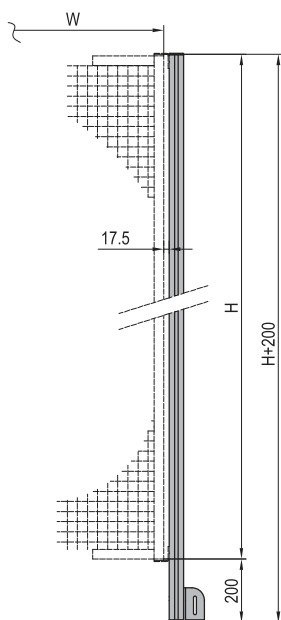

Description	Strut Profile	H (mm)	Part No.
Strut Elements H1400	40x40L	1400	PBH1400.4040.ST
	40x80		PBH1400.4080.SE.ST
	45x45L		PBH1400.4545.ST
	45x90		PBH1400.4590.SE.ST
Strut Elements H1800	40x40L	1800	PBH1800.4040.ST
	40x80		PBH1800.4080.SE.ST
	45x45L		PBH1800.4545.ST
	45x90		PBH1800.4590.SE.ST



Components for Strut Elements

Profile for strut elements

PG40 40x40 4 slots light

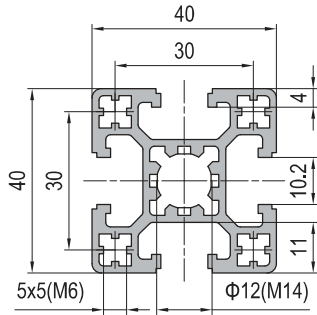

PG45 45x45 4 slots Light

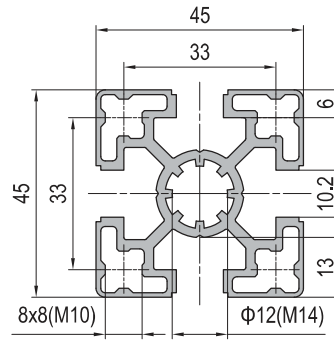

PG40 40x80 6 slots For strut elements

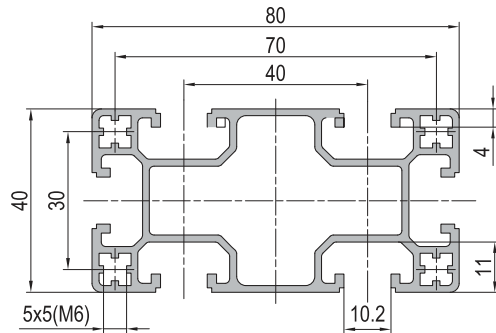

PG45 45x90 6 slots For strut elements

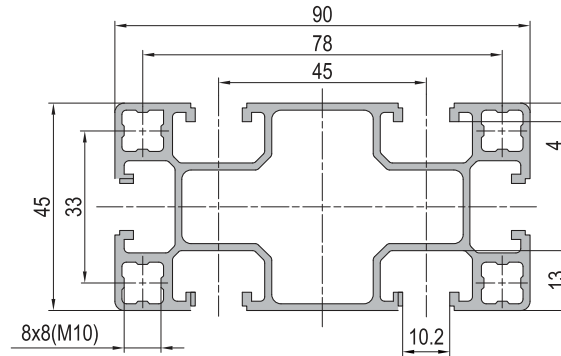

Description	Moment of Inertia $I_x(\text{cm}^4)$	Moment of Inertia $I_y(\text{cm}^4)$	Moment of Resistance $W_x(\text{cm}^3)$	Moment of Resistance $W_y(\text{cm}^3)$	Mass (kg/m)	Part No.
Strut Profile PG40 40x40 4 slots Light	8.6	8.6	4.3	4.3	1.5	1.11.40.040040.04L
PG40 40x80 6 slots For strut elements	13.6	50.7	6.8	12.7	1.83	1.42.40.040080.06.SE
Strut Profile PG45 45x45 4 slots Light	10.5	10.5	4.7	4.7	1.6	1.11.45.045045.04L
PG45 45x90 6 slots For strut elements	20.1	77.2	8.9	17.2	2.2	1.42.45.045090.06.SE





End Cap

To prevent staff from any injury and improve profile end appearance.

Material and Color: black ABS

Type B

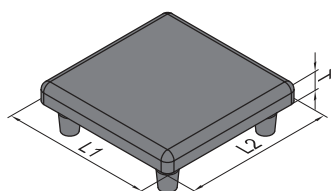

Type C

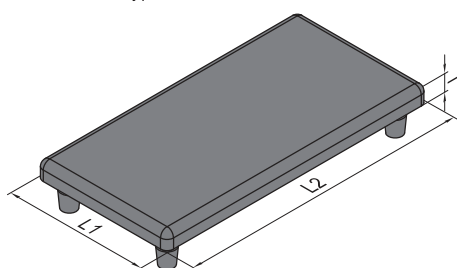

Type F

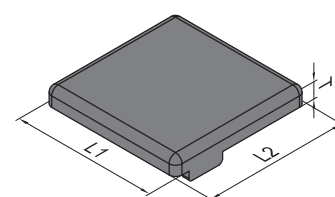

Type G

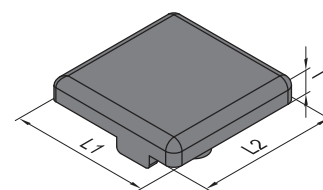

Description		L1 (mm)	L2 (mm)	T (mm)	Mass (g)	Part No.
Type B	End Cap-PG40-4040	40	40	5	6	4.11.40.4040
	End Cap-PG45-4545	45	45		8	4.11.45.4545
Type C	End Cap-PG40-4080	40	80	5	13	4.11.40.4080
	End Cap-PG45-4590	45	90		16	4.11.45.4590
Type F	End Cap-Clamping Profile PG30-3030	30	30	5	4	4.12.30.3030
	End Cap-Clamping Profile PG40-4040	40	40		6	4.12.40.4040
Type G	End Cap-Protective Grille Profile PG30-3030	30	30	5	4	4.13.30.3030
	End Cap-Protective Grille Profile PG40-4040	40	40		6	4.13.40.4040





Base Plate

To support strut profile at the bottom. Expansion bolts chocked into floor can offer a high stability.

Material and surface treatment: cast steel, black electrophoresis

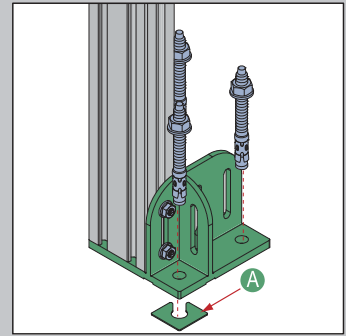

A Base Plate Gasket
To adjust the degree of vertical profile and uneven ground.

Base Plate 4080

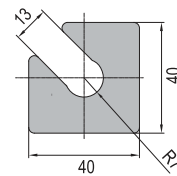
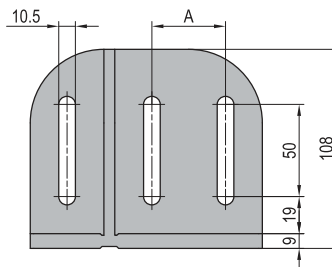
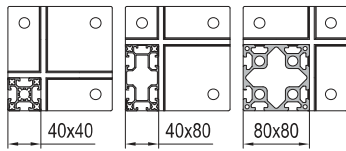
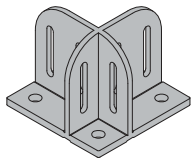

Base Plate 4560

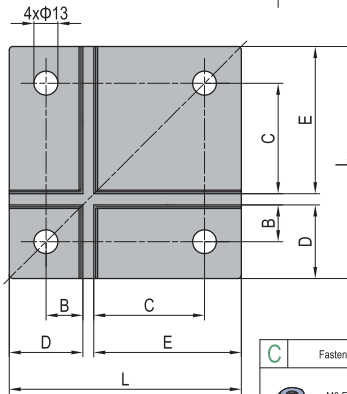
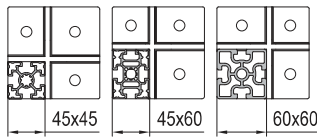
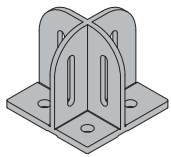

Base Plate 4590

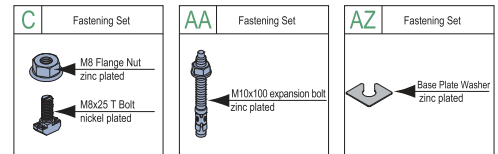
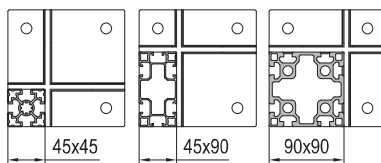
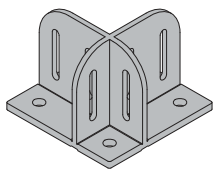

Description	L (mm)	A (mm)	B (mm)	C (mm)	D (mm)	E (mm)	Fastening Set	Mass (g)	Part No.
Base Plate-4080 (pcs)	126	40	20	60	40	80	2xAZ	1930	5.11.4080
Base Plate-4080 (set A)							4xC+3xAA+2xAZ	2240	5.11.4080.STA
Base Plate-4080 (set B)							6xC+3xAA+2xAZ	2290	5.11.4080.STB
Base Plate-4080 (set C)							8xC+3xAA+2xAZ	2340	5.11.4080.STC
Base Plate-4560 (pcs)	111		22.5	30	45	60	2xAZ	1600	5.11.4560
Base Plate-4560 (set)							4xC+3xAA+2xAZ	1910	5.11.4560.ST
Base Plate-4590 (pcs)	141	45	22.5	67.5	45	90	2xAZ	2330	5.11.4590
Base Plate-4590 (set A)							4xC+3xAA+2xAZ	2640	5.11.4590.STA
Base Plate-4590 (set B)							6xC+3xAA+2xAZ	2690	5.11.4590.STB
Base Plate-4590 (set C)							8xC+3xAA+2xAZ	2740	5.11.4590.STC
Base Plate Gasket A								9	5.11.01





Base Plate



To support strut profile mounted between sections of machine guard system, Expansion bolts checked into floor can offer very high stability.

Material and Color: carbon steel, black electrophoresis

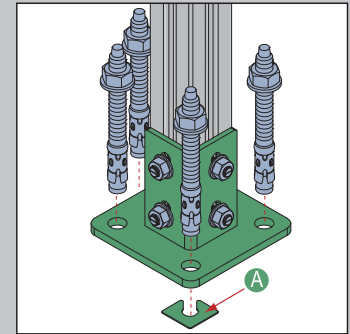

A Base Plate Gasket
To adjust the degree of vertical profile and uneven ground.

Base Plate 40x40/45x45

Base Plate 40x80/45x90

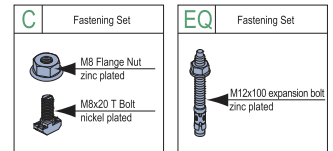
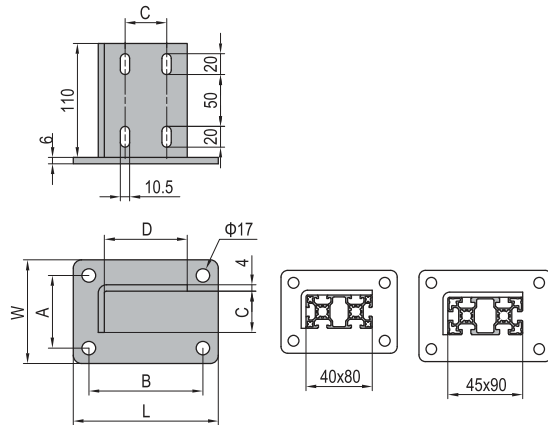
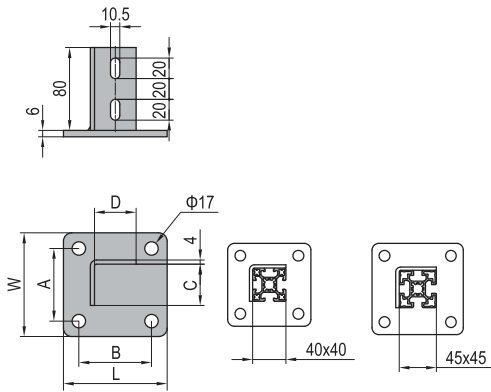

Description	L (mm)	W (mm)	A (mm)	B (mm)	C (mm)	D (mm)	Fastening Set	Mass (g)	Part No.
Base Plate-4040 (pcs)	100	100	70	70	40	40		629	5.13.4040
Base Plate-4040 (set)							4xC+4xEQ	1275	5.13.4040.ST
Base Plate-4545 (pcs)	110	110	80	80	45	45		1022	5.13.4545
Base Plate-4545 (set)							4xC+4xEQ	1710	5.13.4545.ST
Base Plate-4080 (pcs)	140	100	70	110	40	80		753	5.13.4080
Base Plate-4080 (set)							6xC+4xEQ	1400	5.13.4080.ST
Base Plate-4590 (pcs)	160	110	80	130	45	90		1243	5.13.4590
Base Plate-4590 (set)							6xC+4xEQ	1920	5.13.4590.ST





L Base



L base is to fix the profile on the floor and adjust the height of the profile to the floor.

Material: diecast aluminum, black electrophoresis

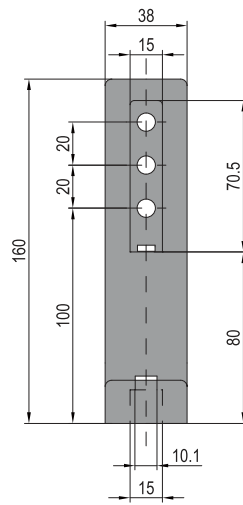
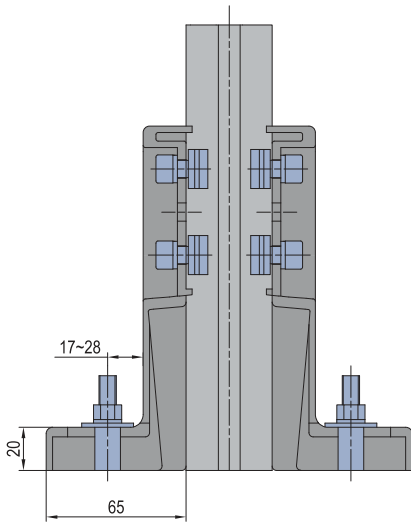
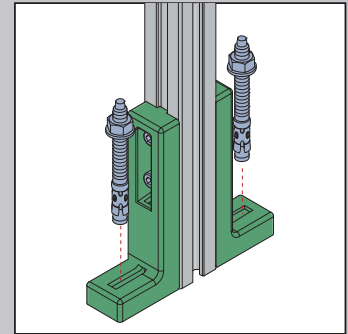

DI	Fastening Set	DM	Fastening Set	DN	Fastening Set
	M8x16 Bolt zinc plated		M8x20 Bolt zinc plated		M10x100 expansion bolt zinc plated
	M8 Spring Washer zinc plated		M8 Spring Washer zinc plated		
	M8 Pre-set Nut nickel plated		M8 Pre-set Nut nickel plated		

Description	Fastening Set	Mass (g)	Part No.
L Base (pcs)		236	5.52.10.P
L Base-PG40 (set)	2xDI+1xDN	303	5.52.10.04.ST.P
L Base-PG45 (set)	2xDM+1xDN	306	5.52.10.06.ST.P





Connecting Element

To connect protective fences with strut element

Material: Die cast zinc

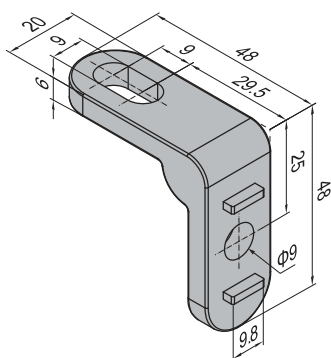
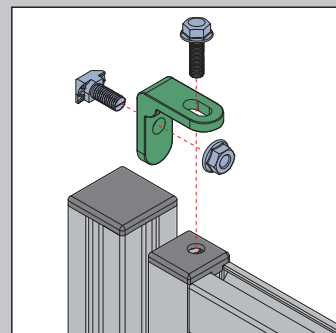
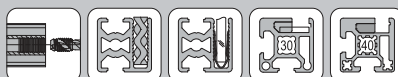

HA	Fastening Set	HB	Fastening Set
	M8x25 Bolt zinc plated		M8x20 Bolt zinc plated
	M8 Flange Nut zinc plated		M8 Flange Nut zinc plated
	M8x20 T Bolt nickel plated		M8x20 T Bolt nickel plated

Description	Fastening Set	Mass (g)	Part No.
Connecting Element for Protective Grille Unit	1×HA	96g	PNC.ST
Connecting Element for Clamping Profile Unit	1×HB	94g	PPC.ST

