

Safety Distance

Machine guard system offers protection against parts that fly out, leaking liquid materials or similar things. The safety distances are dependent on the machine guard height. As figure indicated (safety area is marked in green shadow): Safely distance should be 200mm away from the machine guard. When the height of machine guard is 2000mm, there is still a small part of distance around 350mm from the top cannot get security protection, and it cannot guarantee sufficient safety if the height is less than 1400mm.

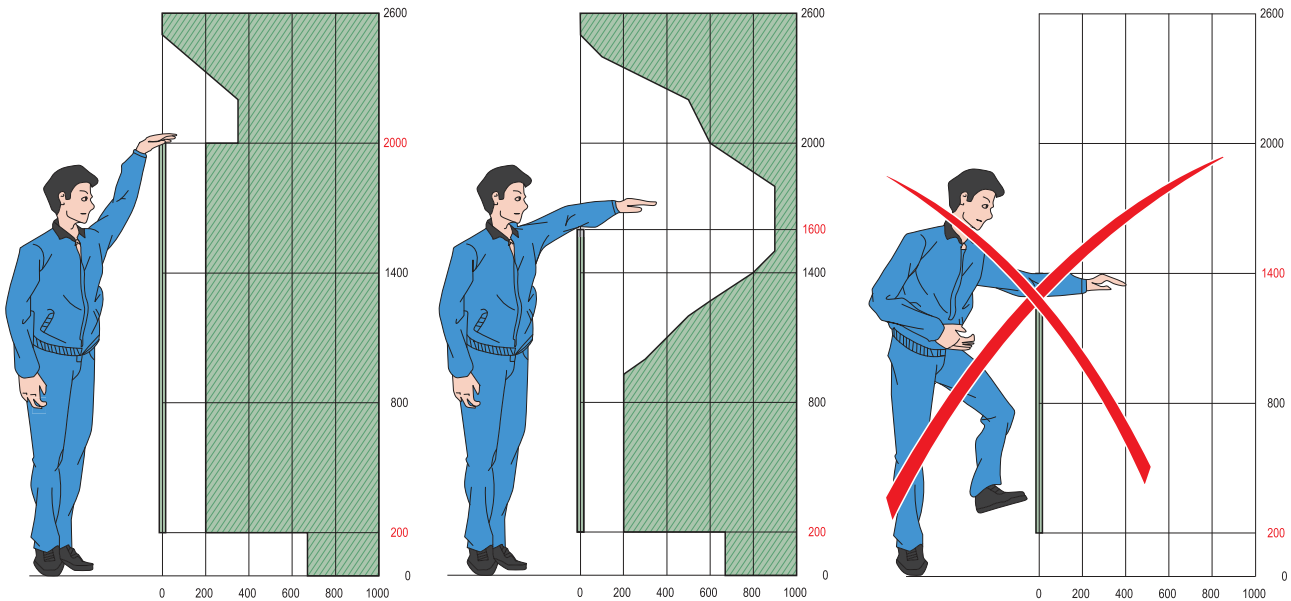

The height from the floor is 200mm. As figure indicated (safety area is marked in green shadow): The distance of 650mm in the foot area cannot get sufficient safety protection.

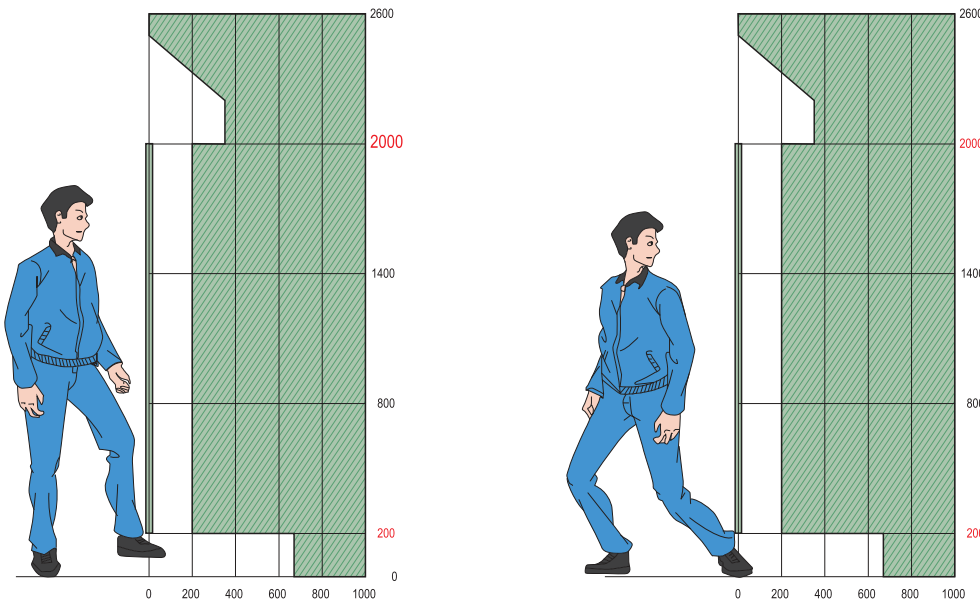

Protective Grille Unit

PG30 Type A

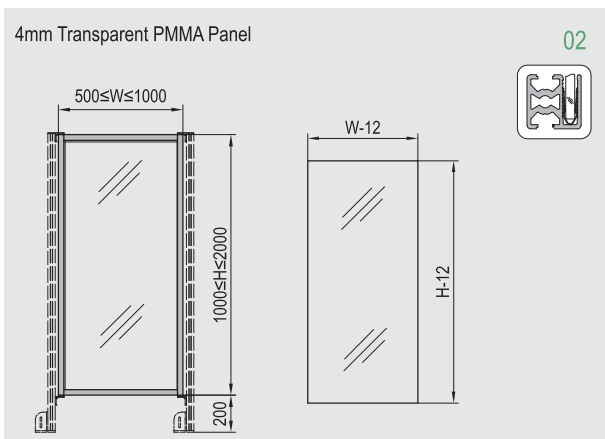
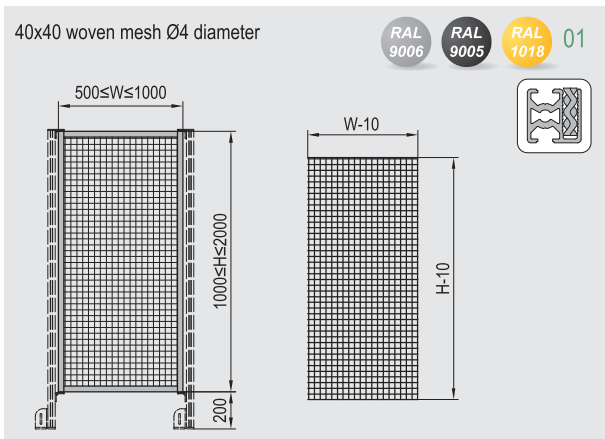

Description	H (mm)	W (mm)	Mass (kg)	Part No.
PG30-Type A-01	1400	425	6.5	PN30.14000425.STA.01
		675	8.8	PN30.14000675.STA.01
		925	11	PN30.14000925.STA.01
	1800	425	8.2	PN30.18000425.STA.01
		675	10.9	PN30.18000675.STA.01
		925	13.7	PN30.18000925.STA.01
PG30-Type A-02	1400	425	6.5	PN30.14000425.STA.02
		675	8.7	PN30.14000675.STA.02
		925	10.8	PN30.14000925.STA.02
	1800	425	8.1	PN30.18000425.STA.02
		675	10.7	PN30.18000675.STA.02
		925	12.9	PN30.18000925.STA.02

Item Number Reference:

The part number is for gray woven mesh in the default configuration, please specify with RAL code if other color is required, such as RAL9005 for black, RAL1018 for yellow.

ex: PN30.14000425.STA.01-RAL9005

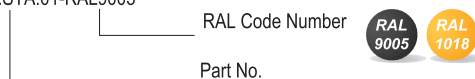

Associated kits (To be ordered separately)



Strut Elements Page 19-24



Connecting Element Page 25



Protective Grille Unit

PG30 Type B

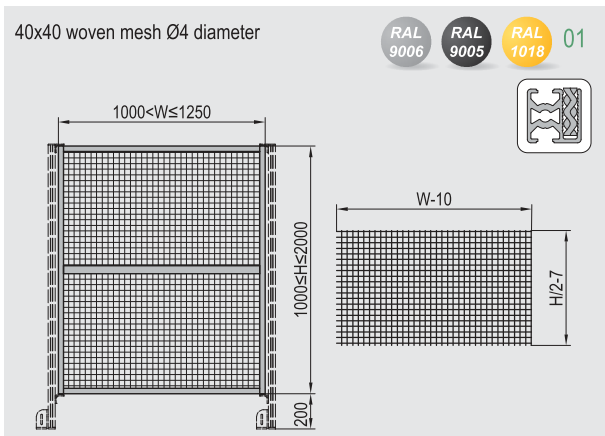

Description	H (mm)	W (mm)	Mass (kg)	Part No.
PG30-Type B-01	1400	1175	14.6	PN30.14001175.STB.01
	1800		17.8	PN30.18001175.STB.01
PG30-Type B-02	1400		14.4	PN30.14001175.STB.02
	1800		17.5	PN30.18001175.STB.02

Item Number Reference:

The part number is for gray woven mesh in the default configuration, please specify with RAL code if other color is required, such as RAL9005 for black, RAL1018 for yellow.

ex: PN30.14001175.STB.01-RAL9005

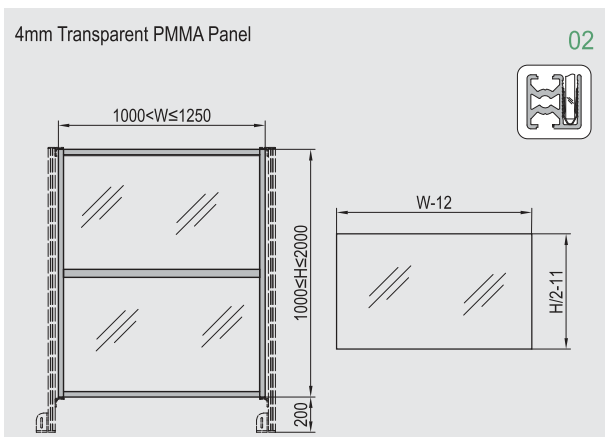
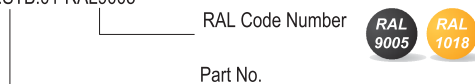

Associated kits (To be ordered separately)



Strut Elements Page 19-24



Connecting Element Page 25

Protective Grille Unit

PG30 Type C

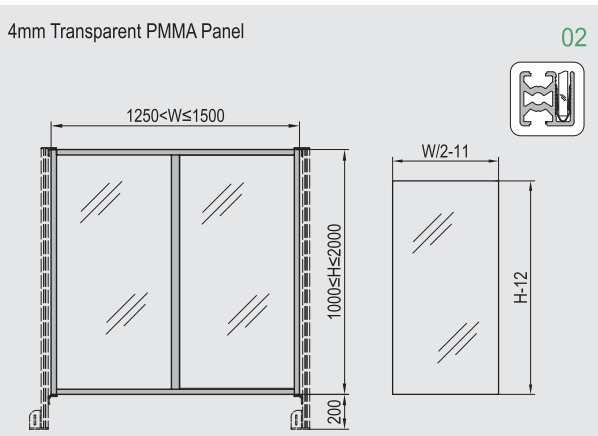
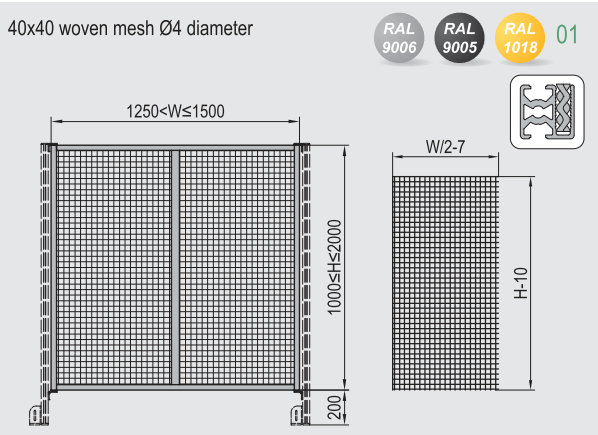

Description	H (mm)	W (mm)	Mass (kg)	Part No.
PG30-Type C-01	1400	1425	17.1	PN30.14001425.STC.01
	1800		21.3	PN30.18001425.STC.01
PG30-Type C-02	1400		16.9	PN30.14001425.STC.02
	1800		20.9	PN30.18001425.STC.02

Item Number Reference:

The part number is for gray woven mesh in the default configuration, please specify with RAL code if other color is required, such as RAL9005 for black, RAL1018 for yellow.

ex: PN30.14001425.STC.01-RAL9005

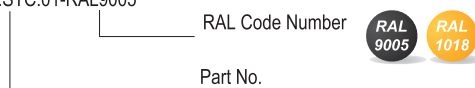

Associated kits (To be ordered separately)



Strut Elements Page 19-24



Connecting Element Page 25



Protective Grille Unit

PG40 Type A

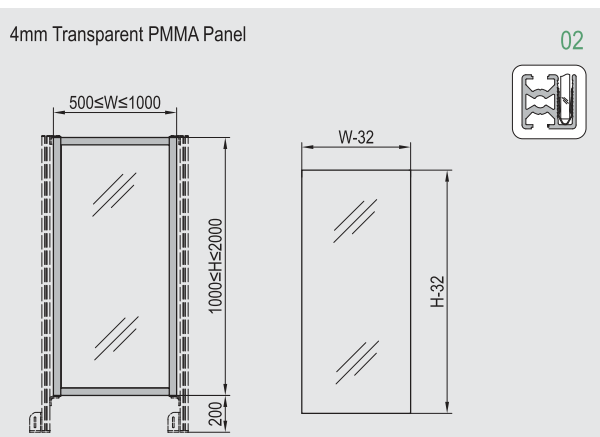
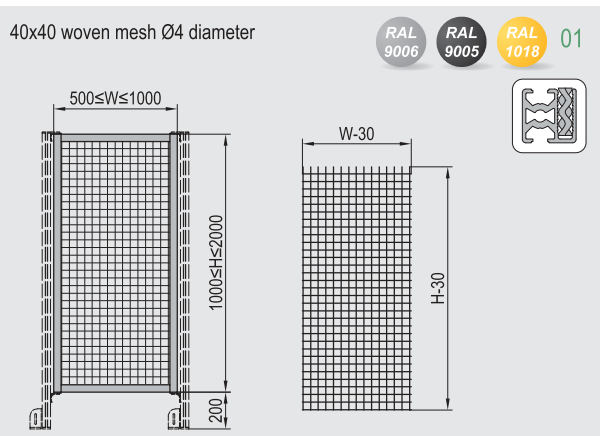

Description	H (mm)	W (mm)	Mass (kg)	Part No.
PG40-Type A-01	1400	420	8.3	PN40.14000420.STA.01
		670	10.8	PN40.14000670.STA.01
		920	13.4	PN40.14000920.STA.01
	1800	420	10.4	PN40.18000420.STA.01
		670	13.4	PN40.18000670.STA.01
		920	16.4	PN40.18000920.STA.01
PG40-Type A-02	1400	420	8.3	PN40.14000420.STA.02
		670	10.7	PN40.14000670.STA.02
		920	13.2	PN40.14000920.STA.02
	1800	420	10.3	PN40.18000420.STA.02
		670	12.5	PN40.18000670.STA.02
		920	16.2	PN40.18000920.STA.02

Item Number Reference:

The part number is for gray woven mesh in the default configuration, please specify with RAL code if other color is required, such as RAL9005 for black, RAL1018 for yellow.

ex: PN40.14000420.STA.01-RAL9005

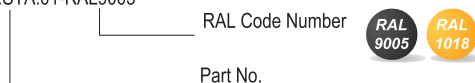

Associated kits (To be ordered separately)



Strut Elements Page 19-24



Connecting Element Page 25



Protective Grille Unit

PG40 Type B

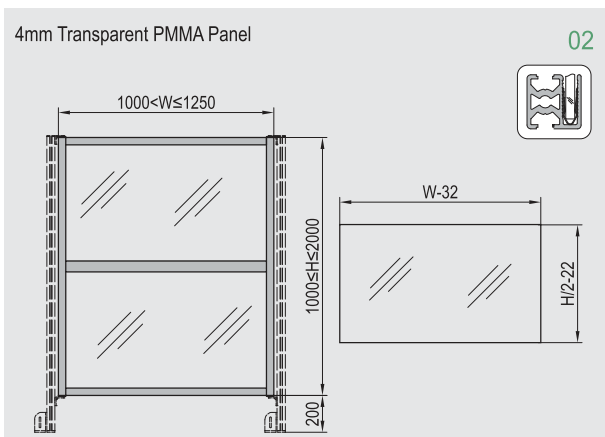
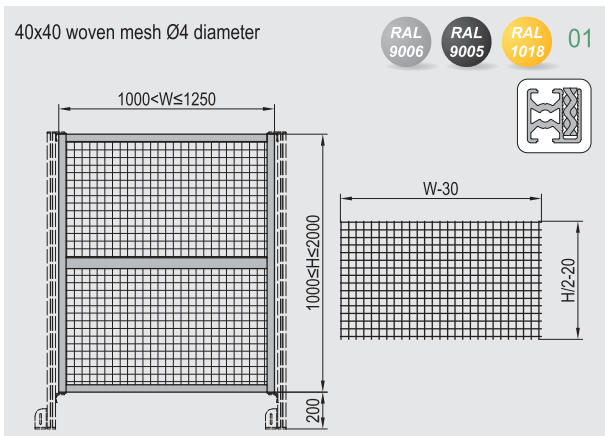

Description	H (mm)	W (mm)	Mass (kg)	Part No.
PG40-Type B-01	1400	1170	18.1	PN40.14001170.STB.01
	1800		21.6	PN40.18001170.STB.01
PG40-Type B-02	1400		17.9	PN40.14001170.STB.02
	1800		23.4	PN40.18001170.STB.02

Item Number Reference:

The part number is for gray woven mesh in the default configuration, please specify with RAL code if other color is required, such as RAL9005 for black, RAL1018 for yellow.

ex: PN40.14001170.STB.01-RAL9005

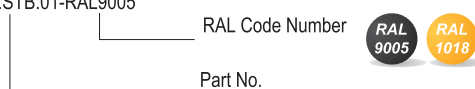

Associated kits (To be ordered separately)



Strut Elements Page 19-24



Connecting Element Page 25



Protective Grille Unit

PG40 Type C

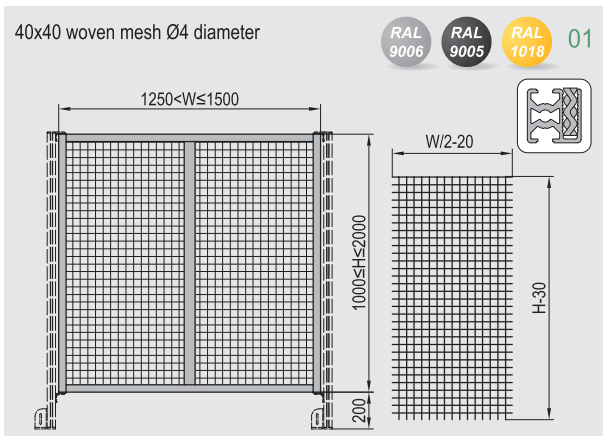

Description	H (mm)	W (mm)	Mass (kg)	Part No.
PG40-Type C-01	1400	1420	21	PN40.14001420.STC.01
	1800		25.9	PN40.18001420.STC.01
PG40-Type C-02	1400		20.8	PN40.14001420.STC.02
	1800		25.5	PN40.18001420.STC.02

Item Number Reference:

The part number is for gray woven mesh in the default configuration, please specify with RAL code if other color is required, such as RAL9005 for black, RAL1018 for yellow.

ex: PN40.14001420.STC.01-RAL9005

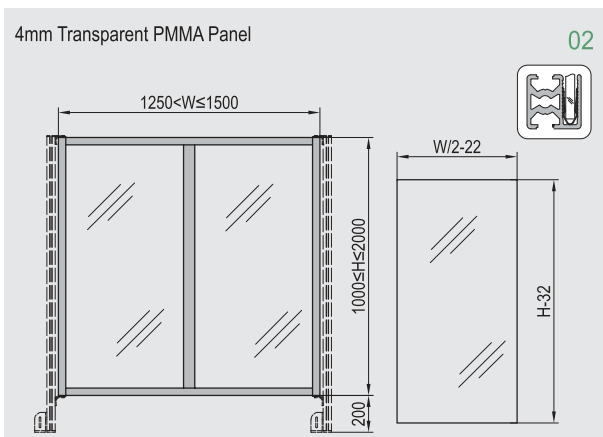
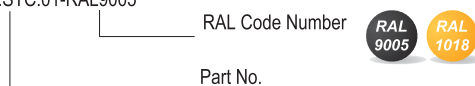

Associated kits (To be ordered separately)



Strut Elements Page 19-24



Connecting Element Page 25



Protective Grille Profile



30x30 1 Grille slot

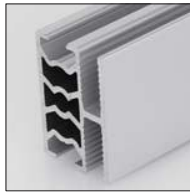

30x45 2 Grille slots



40x40 1 Grille slot

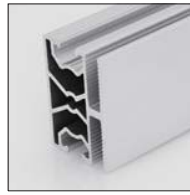

40x60 2 Grille slots

Protective grille profile could insert not only the meshes but also the panels, and the spring clamping nut will be used if inserting panels, the recommended distance of nut is 300mm (refer to Page 14).

PG30 30x30 1 Grille slot

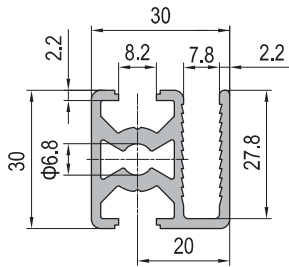

PG30 30x45 2 Grille slots

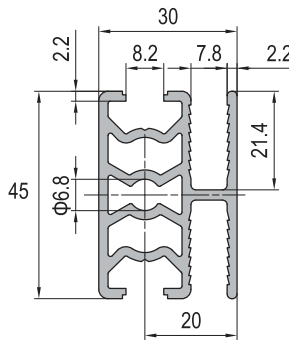

PG40 40x40 1 Grille slot

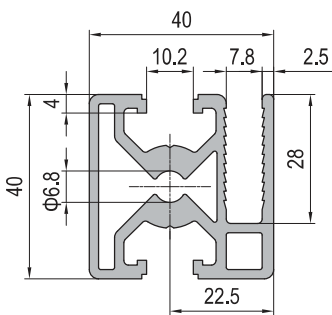

PG40 40x60 2 Grille slots

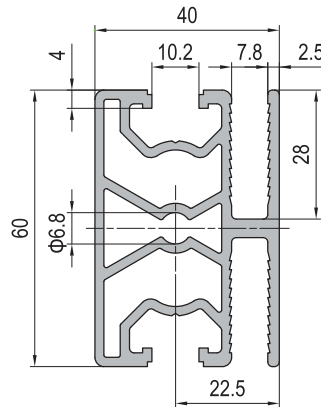

Description	Moment of Inertia $I_x(\text{cm}^4)$	Moment of Inertia $I_y(\text{cm}^4)$	Moment of Resistance $W_x(\text{cm}^3)$	Moment of Resistance $W_y(\text{cm}^3)$	Mass (kg/m)	Part No.
Protective Grille Profile PG30 30x30 1 Grille slot	3.37	2.47	2.2	1.6	0.94	1.22.30.030030.01
Protective Grille Profile PG30 30x45 2 Grille slots	7.22	4.67	4.81	2.08	1.24	1.22.30.030045.02
Protective Grille Profile PG40 40x40 1 Grille slot	9.85	8.05	4.93	4.03	1.6	1.22.40.040040.01
Protective Grille Profile PG40 40x60 2 Grille slots	23.25	13.57	11.63	4.52	2.0	1.22.40.040060.02



Modular Assembly System

MAS

Machine Guard System

MGS

Stair and Platform System

SPS

Tubular Framing System

TFS



Bolt Connector

A simple and economic way to replace end connector with more connection reliability.

Material: zinc plated steel

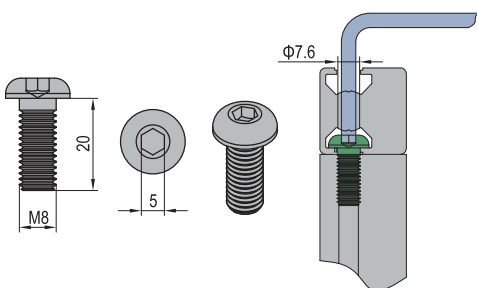
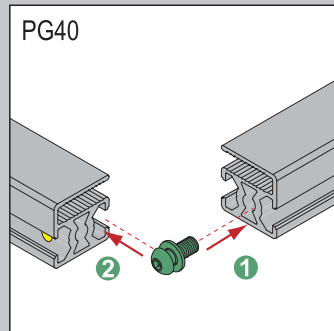

AE	Fastening Set
	M8 Washer zinc plated

Description	Fastening Set	Mass (g)	Part No.
Bolt Connector-PG30		10	3.81.M8.20
Bolt Connector-PG40	1x AE	12	3.81.M8.20.ST



Anti-torsion Subsequent Nut

Prevent torsion from connecting profiles with screw connectors.

Material: nickel plated steel

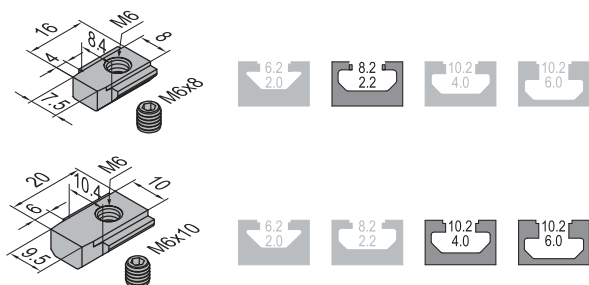
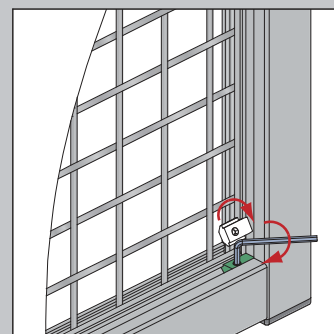
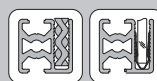

Description	Mass (g)	Part No.
Anti-torsional Subsequent Nut-8(with top thread)	10	2.32.08.M6
Anti-torsional Subsequent Nut-10(with top thread)	15	2.32.10.M6





Spring Clamping Nut

Spring clamping nut has to be used when inserting panels and recommend installing distance is 300mm.

Material: spring steel

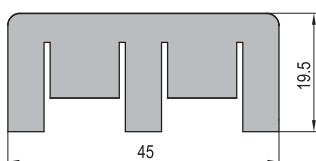
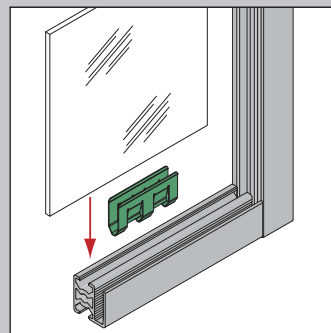

Description	Mass (g)	Part No.
Spring Clamping Nut	7	6.42.01

Modular Assembly System
MAS

Machine Guard System
MGS



End Cap for Protective Grille Profile

To prevent injury and improve end appearance, the bore hole enables assembly of profile and connectors.

Material : Black ABS

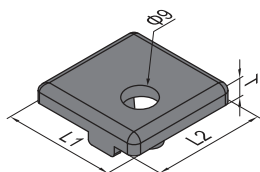
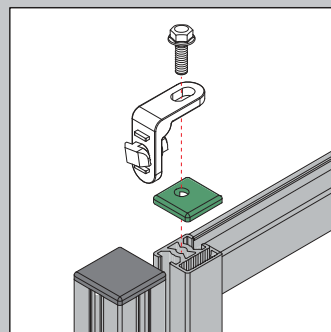

Description	L1 (mm)	L2 (mm)	T (mm)	Mass (g)	Part No.
End Cap for Protective Grille Profile- PG30-3030	30	30	5	4	4.13.30.3030.SM
End Cap for Protective Grille Profile- PG40-4040	40	40		6	4.13.40.4040.SM

Stair and Platform System
SPS

Tubular Framing System
TFS



Clamping Profile Unit

PG30

4mm Transparent PMMA Panel



Type A

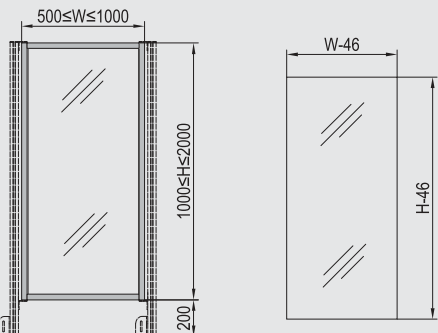

Type B

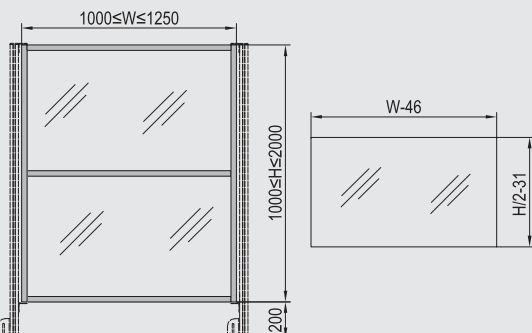

Type C

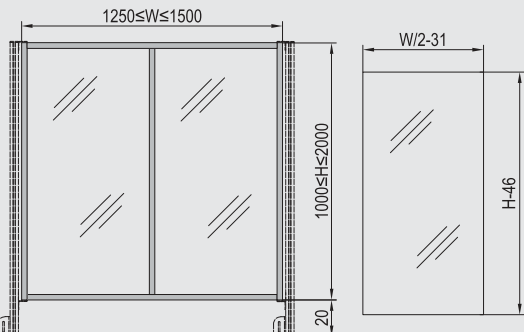

Description	H (mm)	W (mm)	Mass (kg)	Part No.
PG30-Type A	1400	425	6.4	PP30.14000425.STA
		675	8.6	PP30.14000675.STA
		925	10.8	PP30.14000925.STA
	1800	425	8	PP30.18000425.STA
		675	10.7	PP30.18000675.STA
		925	13.4	PP30.18000925.STA
PG30-Type B	1400	1175	15.2	PP30.14001175.STB
	1800		18.2	PP30.18001175.STB
PG30-Type C	1400	1425	17.8	PP30.14001425.STC
	1800		21.3	PP30.18001425.STC

Associated kits (To be ordered separately)



Strut Elements Page 19-24



Connecting Element Page 25



Clamping Profile Unit

PG40

4mm Transparent PMMA Panel



Type A

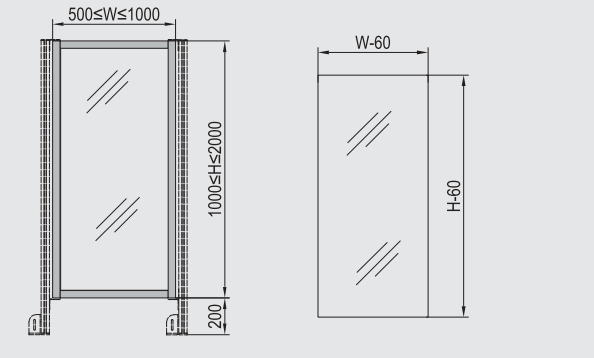

Type B

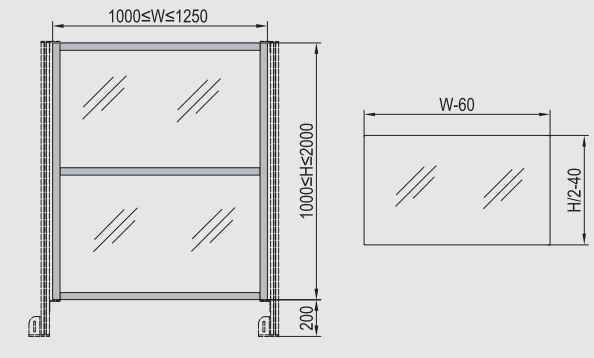

Type C

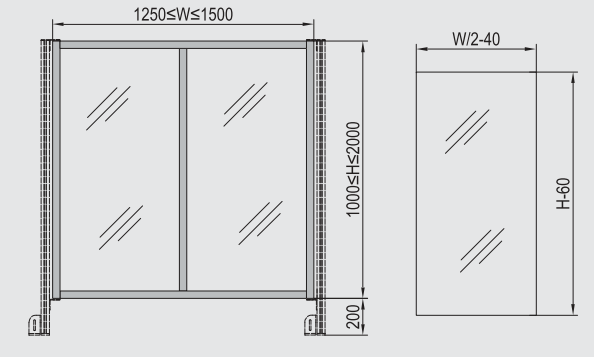

Description	H (mm)	W (mm)	Mass (kg)	Part No.
PG40-Type A	1400	420	10.2	PP40.14000420.STA
		670	12.9	PP40.14000670.STA
		920	15.6	PP40.14000920.STA
	1800	420	12.6	PP40.18000420.STA
		670	15.8	PP40.18000670.STA
		920	19	PP40.18000920.STA
PG40-Type B	1400	1170	20.9	PP40.14001170.STB
	1800		24.8	PP40.18001170.STB
PG40-Type C	1400	1420	24.2	PP40.14001420.STC
	1800		28.5	PP40.18001420.STC

Associated kits (To be ordered separately)



Strut Elements Page 19-24



Connecting Element Page 25



Clamping Profile



30x30 1 Clamping slot



30x30 2 Clamping slots Parallel



40x40 1 Clamping slot



40x40 2 Clamping slots Parallel

Clamping profiles only could insert the panels with thickness range of 1.5-9mm for PG30 and 1.5-10mm for PG40, and machining will be needed on the profiles to fasten the panels in appropriate positions, the recommended distance of machining is 300mm.

PG30 30x30 1 Clamping slot

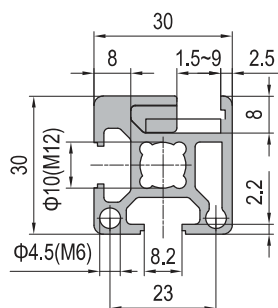

PG30 30x30 2 Clamping slots Parallel

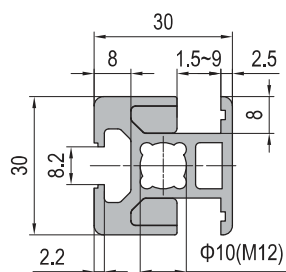

✳ M4x10mm top thread recommended for PG30 profile (panel thickness 3-5mm)

PG40 40x40 1 Clamping slot

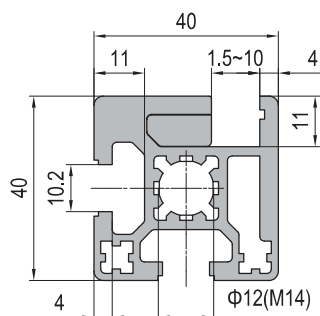

PG40 40x40 2 Clamping slots Parallel

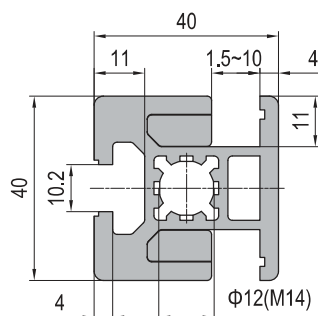

✳ M4x12mm top thread recommended for PG40 profile (panel thickness 3-5mm).

Description	Moment of Inertia $I_x(\text{cm}^4)$	Moment of Inertia $I_y(\text{cm}^4)$	Moment of Resistance $W_x(\text{cm}^3)$	Moment of Resistance $W_y(\text{cm}^3)$	Mass (kg/m)	Part No.
Clamping Profile PG30 30x30 1 Clamping slot	3.7	2.7	1.8	1.4	1.1	1.21.30.030030.01
Clamping Profile PG30 30x30 2 Clamping slots Parallel	3.5	3.3	2.2	2.2	1.3	1.21.30.030030.02P
Clamping Profile PG40 40x40 1 Clamping slot	12.3	9.5	4.4	3.4	2.2	1.21.40.040040.01
Clamping Profile PG40 40x40 2 Clamping slots Parallel	12.4	12.1	5.8	6.1	2.6	1.21.40.040040.02P





Bushing

To realize quick installation of clamping profile unit with connecting elements.

Material : zinc plated steel

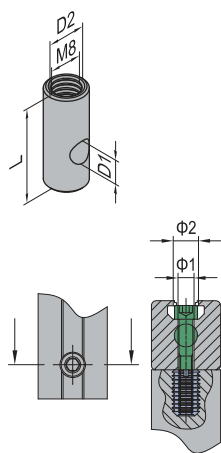
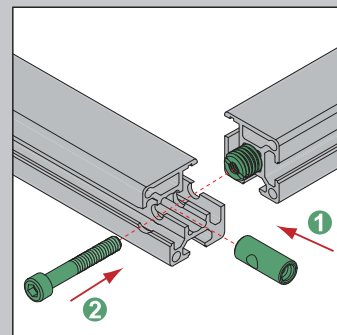

CI	Fastening Set	GD	Fastening Set
	M6x40 Bolt zinc plated		M8x45 Bolt zinc plated
	M12→M6 Hole Reducer Bolt nickel plated		M14→M8 Hole Reducer Bolt nickel plated

Description	L	D1	D2	Φ1	Φ2	Fastening Set	Mass (g)	Part No.
Bushing-PG30 (set)	25	6	10	7	11	1xCI	20	PPJ30.ST
Bushing-PG40 (set)	30	8	12	9	14	1xGD	40	PPJ40.ST



End Cap for Clamping Profile

To prevent injury and improve end appearance, the bore hole enables assembly of profile and connectors.

Material : Black ABS

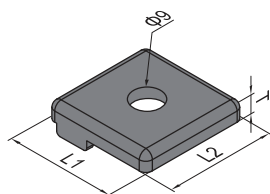
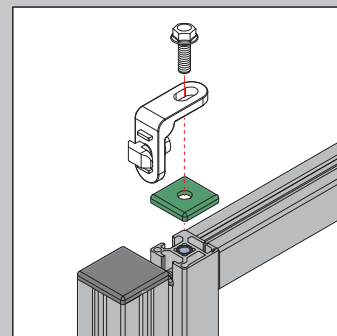
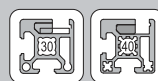

Description	L1 (mm)	L2 (mm)	T (mm)	Mass (g)	Part No.
End Cap for Clamping Profile-PG30-3030	30	30	5	4	4.12.30.3030.SM
End Cap for Clamping Profile-PG40-4040	40	40		6	4.12.40.4040.SM

