

Door and Window Elements

Door lock

Material: DoorLock-black electrophoresis
Block-diecast aluminum, black electrophoresis

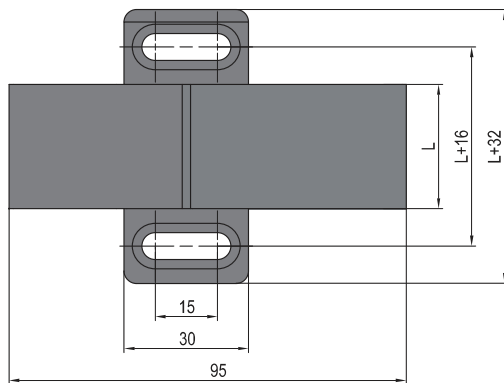
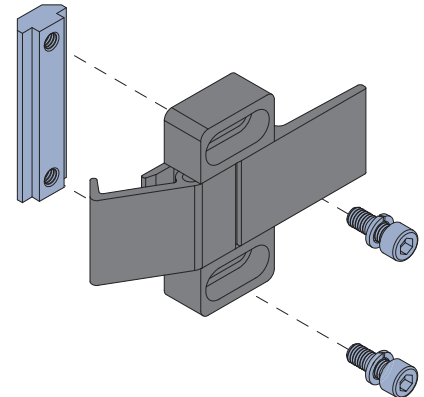
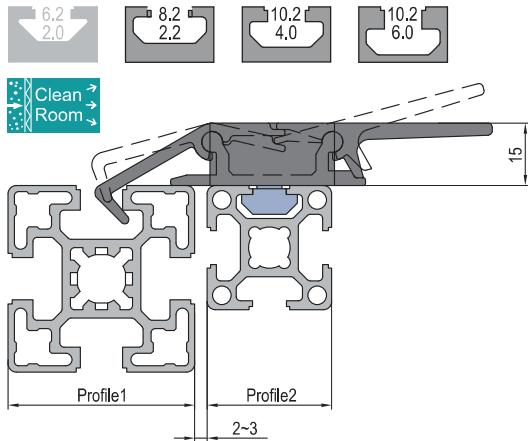

| Description | Profile 1 | Profile 2 | L (mm) | Fastening Set | Mass (g) | Part No. |
|-----------------|-----------|-----------|--------|---------------|----------|--------------|
| Door Locks-3040 | PG40 | PG30 | 30 | 2xCU+1xEP | 115 | 7.42.30.3040 |
| Door Locks-3045 | PG45 | PG30 | | | 115 | 7.42.30.3045 |
| Door Locks-4040 | PG40 | PG40 | | | 140 | 7.42.30.4040 |
| Door Locks-4045 | PG45 | PG40 | 50 | 2xCU+1xEP | 185 | 7.42.30.4045 |
| Door Locks-4545 | PG45 | PG45 | 50 | 2xCV+1xEP | 187 | 7.42.30.4545 |

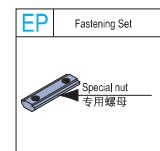
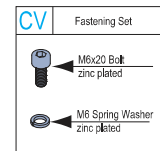
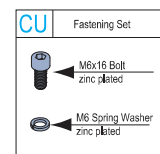

Note: including block and special nut.

2 The length could be customized according to customer's requirement(30~80mm)

ex: 7.42.30.3040 - 50

